

Step 3:
Take out the Sampling Device and ensure that the piston is right above the indicator hole.

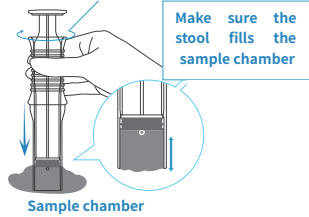

Step 4:
Insert the device vertically into stool, rotate 2~3 times and then pull out after the sample chamber is filled. Insert again if the sample chamber is not full.



Step 5:
Insert the device into the Collection Tube, push the stool down into the tube and then discard the device.

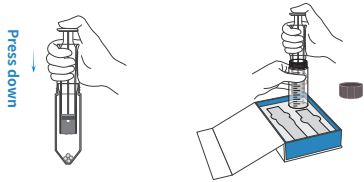

Step 6:
Tighten the Collection Tube cap firmly to prevent leakage.

Tighten the cap firmly

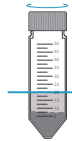

The liquid level is about 20 mL

Step 7:
Write your detail (Name, Age, Gender, Phone number) on the Ziplock Bag label, then put the Collection Tube inside the Ziplock Bag and place the bag into the box. Mail it to the address of the testing laboratory where you obtain the Stool Collection Device. The sample package should arrive at the stated testing laboratory within 5 days after the collection.

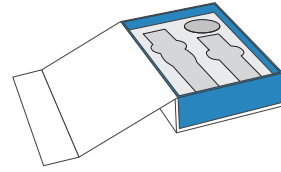

Step 8:
After the collection of stool sample, the used Disposable Stool Collection Carton, Sampling Device and Disposable Gloves should be disposed according to the local garbage classification.

LIMITATION

The device has been developed for collecting shaped stool only.

SYMBOLS

IVD In Vitro Diagnostic Use	See Instruction for Use	Expiry Date	Manufacturer
Tests per Kit	Manufacturing Date	Keep Dry	Store between 4~30°C
LOT Batch Number	Authorized Representative	Keep away from Sunlight	REF Catalog #
Do not reuse			



Creative Biosciences (Guangzhou) Co., Ltd.

6F of Building A2, No.11 Kaiyuan Road, Science City,
Guangzhou High-Tech Industrial Development Zone, 510530
Guangzhou, Guangdong, P.R. China.
Tel: +86 20 82037860
E-Mail: Service@creativebio.cn
Webseite: <https://en.creativebio.cn/>



Obelis s.a.

Bd. Général Wahis 53, B-1030 Brussels, Belgium.
Tel: 32.2.732.59.54
Email: mail@obelis.net



INSTRUCTION FOR USE OF STOOL COLLECTION DEVICE

KLM-100101

INTENDED USE

Stool Collection Device is used for collecting and preserving stool sample.

SPECIFICATION

1 test/kit

COMPONENT DIAGRAM

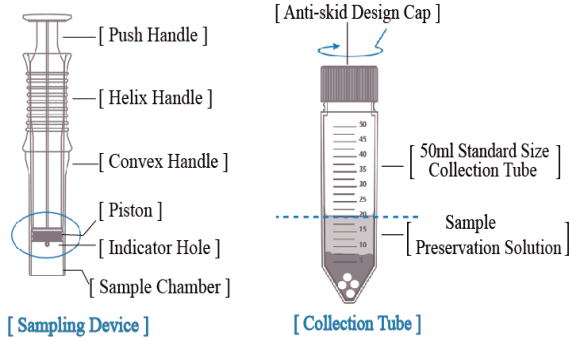

MATERIAL PROVIDED

- Disposable Stool Collection Carton 1
- Sampling Device (Disposable) 1
- Collection Tube 1
- Disposable Gloves 1
- Instruction for Use 1
- Ziplock Bag 1

STORAGE AND STABILITY

1. Store at 4°C~30°C in a dry place for up to the expiration date provided on the package.
2. Shelf life is 18 months under normal storage condition.

SAMPLE REQUIREMENTS

1. The device is only for shaped stool sample.
2. The stool sample should be placed in the original box and shipped out immediately to the address of the testing laboratory where you obtain the Stool Collection Device. The sample package should arrive at the stated testing laboratory within 5 days after the collection.

WARNINGS AND PRECAUTIONS

1. For in vitro diagnostic use only.
2. Intended for single use only. Do not reuse.
3. Carefully follow the directions described in this instruction for use.
4. Do not use after the expiration date provided on the package.
5. Stool sample may be potentially infectious. Proper handling and disposal should be strictly followed.
6. The device is only for shaped stool to ensure accurate detection results. Loose or watery stool is not allowed.
7. Please place stool in the Disposable Stool Collection Carton provided and collect the sample right away. Make sure no urine or water contaminating stool sample.
8. Only one full sample chamber of stool is enough.
9. Use caution while pushing the stool sample into the Collection Tube and make sure the cap is tightened afterwards to prevent any leakage.
10. The correct volume of stool sample liquid should be around 20ml after the stool sample is put in the Collection Tube.
11. Disposable Gloves are provided for hygiene purpose.
12. Sample preservation solution in the Collection Tube is not drinkable! Please keep this product out of reach of children.

13. The preservation solution in the Collection Tube can irritate skin. In case of accidental contact, rinse with plenty of water and seek medical advice if necessary. If you swallow it by mistake please rinse your mouth and seek medical advice immediately.
14. NOTICE: Any serious incident that has occurred in relation to the device should be reported to the manufacturer and the competent authority of the Member State in which the user and/or the patient is established.

DIRECTION FOR USE

Please follow the steps below for stool collection:

Preparation Before Collection

Place the Disposable Stool Collection Carton in the toilet or squat toilet. Adjust to the proper position to ensure that the stool is discharged into the carton.

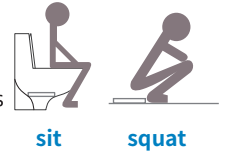

Sample Collection Procedure

Step 1:

Put on Disposable Gloves to get ready for sample collection.

Step 2:

Insert the Collection Tube vertically into the round hole inside the box and twist off the cap.

